

PUBLISHER'S NOTE
The acreage and owners names shown on this Atlas are based upon records obtained from the 1934 official assessment list.
However, due to the magnitude of the details involved, supplementary information has been rendered by many property owners, in answer to our questionnaire, thus enabling the finished edition to be complete, accurate and reliable.

LEGEND
FRAME BUILDING
BRICK BUILDING
STONE OR CONCRETE
STONE OR BRICK 1/2 FRAME 2nd
STABLE OR GARAGE
GREEN HOUSE
IRON OR IRONCLAD
STEAM RAILROAD
TOWNSHIP OR BOROUGH LINE
MINES
QUARRIES
WATER PIPE & SIZE
PAVED STREET OR DRIVE
UNPAVED STREET OR DRIVE
FIRE HYDRANT
ADJOINING PLATE
ELECTRIC HIGH TENSION OR TRANSMISSION LINES

PART OF EAST VINCENT TOWNSHIP

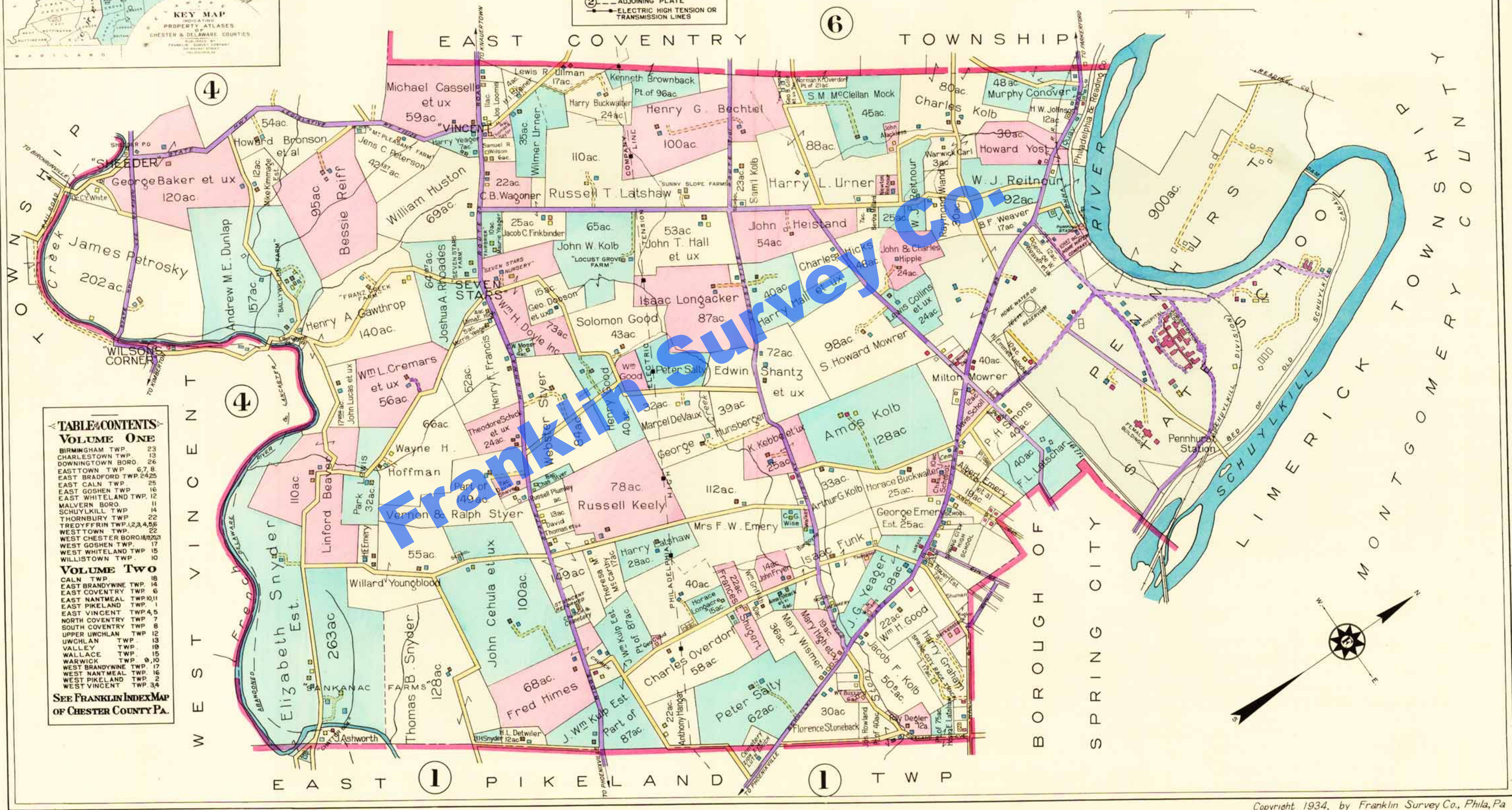

TABLE OF CONTENTS
VOLUME ONE
BIRMINGHAM TWP. 23
CHARLESTOWN TWP. 13
DOWNTOWN BORO. 26
EAST TOWN TWP. 67, 8
EAST BRADFORD TWP. 24, 25
EAST CALN TWP. 25
EAST GOSHEN TWP. 16
EAST WHITELAND TWP. 12
MALVERN BORO. 11
SCHUYLKILL TWP. 14
THORNBURY TWP. 22
TREDYFFRIN TWP. 12, 3, 4, 5, 6
WEST TOWN TWP. 22
WEST CHESTER BOROS. 20, 21
WEST GOSHEN TWP. 17
WEST WHITELAND TWP. 15
WILLISTOWN TWP. 10
VOLUME TWO
CALN TWP. 18
EAST BRANDYWINE TWP. 14
EAST COVENTRY TWP. 6
EAST NANTMEAL TWP. 10, 11
EAST PIKELAND TWP. 1
EAST VINCENT TWP. 4, 5
NORTH COVENTRY TWP. 7
SOUTH COVENTRY TWP. 8
UPPER LINCHLAN TWP. 12
UNCLAN TWP. 13
VALLEY TWP. 10
WALLACE TWP. 15
WARWICK TWP. 9
WEST BRANDYWINE TWP. 16
WEST NANTMEAL TWP. 17
WEST PIKELAND TWP. 2
WEST VINCENT TWP. 3, 4
SEE FRANKLIN INDEX MAP OF CHESTER COUNTY PA.

